

REV	DESCRIPTION	DRAWN	DATE

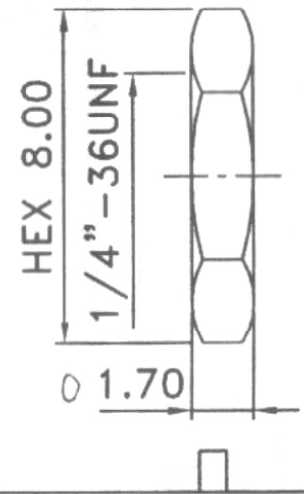
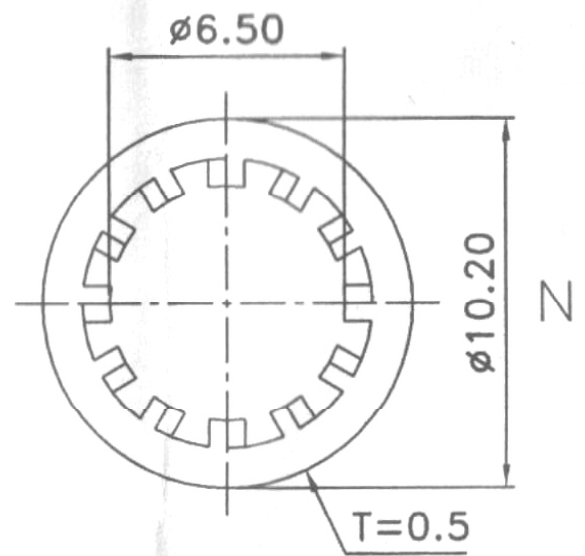
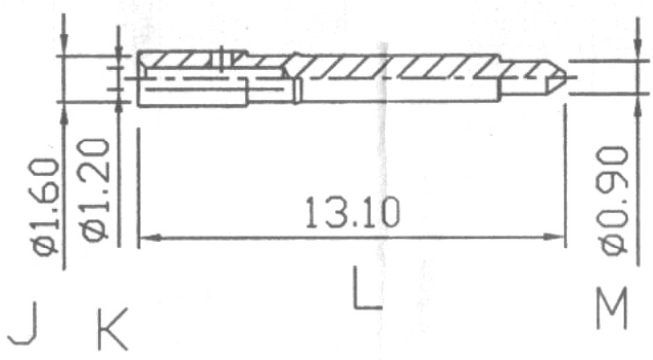
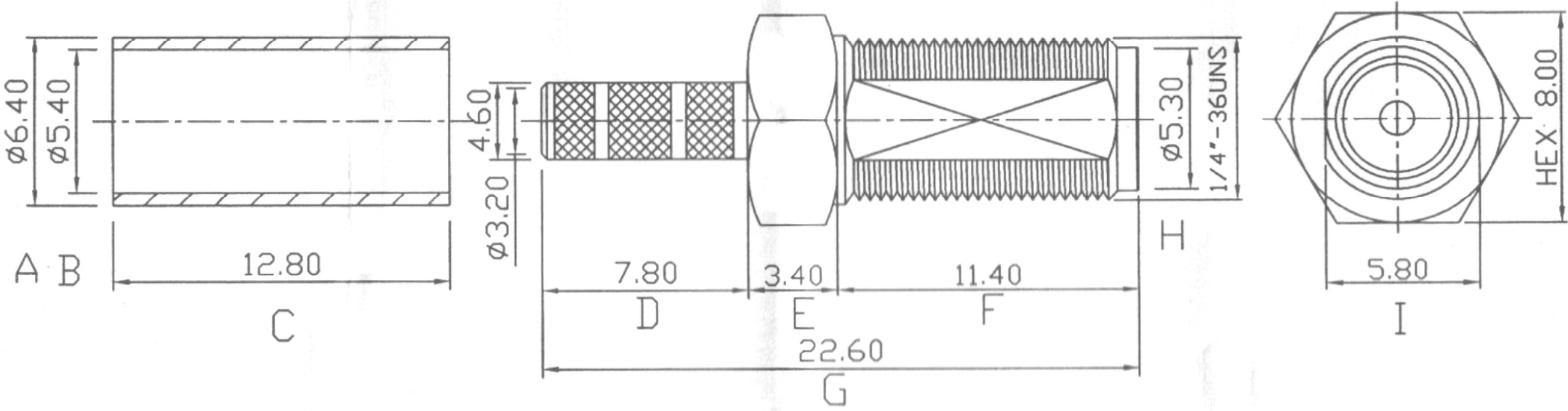

6	NUT	1	BRASS	GOLD
5	WASHER	1	BRASS	GOLD
4	FERRULE	1	COPPER	GOLD
3	DIELECTRIC	1	TEFLON	NONE
2	PIN	1	BERYLLIUM	GOLD
1	BODY	1	BRASS	GOLD

UNLESS OTHERWISE SPECIFIED  
 1. REMOVE ALL BURRS.  
 2. BREAK ALL CORNERS & EDGES 0.15 MAX.  
 3. CHAMFER 1ST & LAST THREADS 45°.  
 4. DIAMETERS ON COMMON CENTERS.  
 TO BE CONCENTRIC WITHIN 0.1 TIR.  
 5. ALL DIMENSIONS ARE AFTER PLATING.

MAJOR DIMENSION  
 UNLESS OTHERWISE NOTED TOLERANCES  
 0.5-6=±0.2  
 6-30=±0.4  
 30-120=±0.6  
 120-315=±1.0  
 ANGLES=±1°

APPROVED [Signature]  
 CHECKED [Signature]  
 DRAWN CHAI  
 DRAWN DATE 01/12/05

TITLE SMA FEMALE RP BULKHEAD CRIMP  
 DRAWING NO. SMA-1012-32-F2-RP-TGG  
 REV A  
 LY

NO	Description	Q'ty	Material	Finish	SCALE	UNIT	MM	FILE NO.
					9/2			